

HOMEAID

ORANGE COUNTY

BUILDING
HOPE &
HOMES FOR THE
TEMPORARILY
HOMELESS

VOL. 6 / ISSUE NO. 2



Making a Difference

IS A GROUP EFFORT

PRECIOUS LIFE “I was 19 years old, scared and angry. Not only was I five months pregnant, I was not married. Deserted by the one who supposedly loved me....not knowing where to turn, I found myself checking into Precious Life Shelter.”

Elizabeth's story (details on page 3) is similar to many told by homeless pregnant women throughout Southern California. Thanks to the support and programs of Precious Life, and the commitment of HomeAid and their building industry partners, Elizabeth's story is one with a happy ending.

Located in Los Alamitos, Precious Life serves homeless women with newborns and pregnant women like Elizabeth, who are at least 18. These women may have children from other relationships and need both housing and childcare, the cost of which is prohibitive for many employed residents trying to obtain self-sufficiency.

To meet that need, Centex Homes is leading the way as the builder captain for Precious Life Shelter's newest addition. This 5,000 square foot facility adding 12 beds is designed to serve primarily as a childcare center. The two-story building will also include a living unit for the house manager, a kitchen, and a handicap accessible unit. Construction is slated for a 90-day completion target date, one of the shortest construction phases for HomeAid.

The Centex Homes culture and their company is both people and community-oriented, as is evidenced by their ongoing involvement with HomeAid, and now their leadership on the Precious Life Shelter project. One of America's top homebuilders for nearly 50 years, Centex Homes builds in 64 metro markets in 20 states, and has garnered *Professional Builder's* “Giant 400” designation every year since the survey was first published 30 years ago.

(Continued on page 02)

President's Message



As the incoming president, I would first like to acknowledge the trade contractors, suppliers, home builders, land developers, and volunteers who have been - and continue to be - a part of building lives, dreams and futures. Words cannot begin to express how much your involvement is appreciated. Thank you.

Recently, I was invited to participate in the Interval House dedication ceremony where, as the builder captain for the project, I had the opportunity to meet some of the young people whose lives were profoundly affected by their involvement with the shelter programs. As I stood there amongst the smiling faces and success stories, I had no doubt as to why I was involved with this project and HomeAid. It was a very rewarding experience.

Interval House, and all of the shelters spear-headed by HomeAid Orange County, would not become a reality without the unwavering support of trade partners, suppliers and volunteers who keep coming back to offer their talent and resources.

As a token gesture of appreciation for your work with HomeAid, the Building Industry Association's Orange County Chapter and HomeAid Orange County recently invited our trade partners to be our guest at the annual P.A.S.S. Beach Bash. It was our way of expressing our sincere gratitude for all you have done to help the homeless we serve.

As we look forward to our continued work in building shelters for the homeless, we can all be proud in the knowledge that nearly half of the existing transitional beds in Orange County were built by HomeAid. What an outstanding accomplishment!

Les Thomas
Shea Homes Southern California Division

(Precious Life continued from page 01)

Under the guidance of Roland Osgood, president, Centex Homes South Coast Division; Jim Guccione, vice president of operations; and Timi Flowers, director of purchasing; Centex Homes has recruited the following trade partners to date:

Capital Drywall	Davis Brothers Framing	Martinez Construction
Centex Design Center	Gouvis Engineering California	Pro Heating & Air
Consolidated Reprographics	Horizon Plumbing	Reed Thomas Company, Inc.
Custom Quality Millwork	Hunsaker & Associates	Whirlpool Corporation

Working together, JBZ Architects + Planning, the architects for the project; Centex Homes, along with their trade partners; HomeAid Orange County; and Precious Life Shelters are creating a caring, family-like environment where residents can begin getting their lives back on track. Not only are lives changed at the Precious Life Shelters, these mothers and their newborns learn that they are truly valued and loved. Life is indeed precious.

CENTEX HOMES

SOUTH COAST DIVISION

Girls Hope Contributors List

GIRLS HOPE



Led by Janice Ramsay (second from left) and Lynne MacVean (far right), this group of National Association of Women in Construction volunteers - working in partnership with HomeAid Orange County - successfully remodeled a 3,226 square-foot Girls Hope residence. Girls Hope is an educationally-focused program that serves young women at risk. Without the structure, guidance and opportunities provided by Girls Hope, these academically capable students may not develop to their full potential.

At a recent celebration held on site, Girls Hope and HomeAid Orange County honored the National Association of Women in Construction and over 120 individuals who contributed to the renovation of their Fullerton home.

Girls Hope provides a safe, stable home for six girls between the ages of 10 and 18. A crucial element of their program is to provide children with unfulfilled academic growth, the opportunity and the environment in which to nurture their promise. These kids may be hurt and at risk, yet academically capable of reaching their potential if given the chance in a family-like, value-centered home, like Girls Hope. Congratulations to all who worked so hard to build a home and a foundation for the futures of these young women.

- | | |
|---|---|
| A-G Sod Farms, Inc. | JJ Floor Covering, Inc. |
| Jerry Agair | Bernie Johnson |
| Geoffrey Arther | Just Wood Floors |
| Airelink Products Corporation | Kenneth G. Brown & Company |
| Brian Alandar | Jill Kone |
| American Electric Supply | Leslie Kerney |
| American Technologies, Inc. | Mike Kramer |
| Angelus Block Company, Inc. | Lasco Bathware |
| Associated Heating & Air | Mike Lawson |
| Assurance Capital | Linda D. Coats Surety Services |
| B. & B. Plumbing, Inc. | Linea, Inc. |
| Banner Construction | Karen Lucian |
| Scot Berlinski | Amy MacVean |
| Dick Berry | Charles & Ellen MacVean |
| Biltmore Communities, Inc. | Lynne MacVean |
| Jane Bofenkamp | Mammoth Electric, Inc. |
| Bobsa Nursery, Inc. | Matthews Patch Plastering |
| Boys Hope/Girls Hope of California, Inc. | Kathy McCord |
| Brookfield Homes | Mike Meier |
| Stephanie Burgess | Blair Meixell |
| C.D. Electric | Noberto Mejia |
| Catherine Cardona | Meyer & Reeder, Inc. |
| Carmel Architectural Sales | Midori Gardens |
| Jose Carrillo | Anne Miller |
| Madeline Chapman | Richard Moren |
| Circle Kustom Exterminators | Sandy Mullion |
| City of Brea | NAWIC |
| CLS, Inc. | Nicholas Lane Contractors, Inc. |
| Guy Cnup | Nova Plumbing, Inc. |
| Contractors Bonding & Insurance Company | Omni Systems |
| Tom & Cory Cottage | Jeff Oskins |
| Couts Heating & Cooling, Inc. | Pacific Rim Construction |
| Creative Design Consultants, Inc. | Pacific Spray-On Systems |
| Don Cruz | PDC Facilities, Inc. |
| Pat Dalton | Krystal Peterson |
| Randy Daniels | Proserve Plumbing & Drain |
| Day Star Industries, Inc. | Prudential Lighting |
| Joey DeLuca | PTI Installations, Inc. |
| David Doten | Quality Glass Works |
| Dupont Flooring Systems | Quality Rain Gutters |
| Durigon Plastering | R.D. Obson Construction |
| Matt Economakos | R.L. Douglass Electric, Inc. |
| Ed Hodges Construction | Janice Ramsay |
| Equal Air Balance Company, Inc. | Jeannie Reynolds |
| Victor Florez | Rick Reynolds, Sr. |
| Valerie Freeman | Scott Ripelinger |
| Al Frost | Gerry Robbins |
| G.R. Reynolds Stucco & Plastering Contractors | Gil Rodriguez |
| General Electric Supply | Mel Romero |
| Shelly Gentry | Shelly & Jim Rosier |
| Thomas Getz | Lisa Ruen |
| Greenwest Nursery, Inc. | SCI |
| GTE | Sea Pointe Construction |
| Handyman Connection | Sheet Metal, Air Conditioning Contractors |
| Harbor Wholesale Electric Supply, Inc. | Sherman/Parent Insurance Brokers |
| Justin Heacock | Andy & Sally Shore |
| Dolly & Joe Hernandez | Elna Simmons |
| Mike Hernandez | S. California Air Conditioning Dist. |
| Renee Hernandez | Standard Concrete |
| Kim Hobbs | Lisa Stepanski |
| Jennifer Holek | Supervisor Todd Spitzer |
| Home Depot | Hocartin Electric, Inc. |
| Horizon High Reach | Trimco Finish |
| Ruthie Horner | Martha Unickel |
| IDEA | Valley Crest Trees |
| Imperial Sprinkler | Barry Van Fossan |
| Interior Management, Inc. | Mark Van-Hyfte |
| International Custom Enterprises, Inc. | Steven C. Vargas |
| Ivy Hi-Lift | Village Nursery, Inc. |
| J & M Contracting, Inc. | Debbie Warner |
| Jay & Renfro | Western Air & Refrigeration |
| | Whitehouse Brothers Painting |

Message from the Executive Director

In this issue we are highlighting the expansion of Precious Life Shelter in Los Alamitos. Being built is a 5,000 square-foot, 12-bed facility, which will also serve as a childcare center for Precious Life residents. Centex Homes is leading the way as builder captain for the project, with a slated start date of late September. JBZ Architects + Planning is providing the architectural element.

We are looking forward to working once again in partnership with Theresa Murphy and her dedicated staff and volunteers. Please take a moment to read her letter featured in this issue, and also the heart-felt testimony from a Precious Life resident whose life was dramatically changed as a direct result of her encounter with Precious Life.

HomeAid is extremely grateful for all those who are a part of this wonderful undertaking. When Precious Life III is completed it will be the 37th HomeAid shelter to serve Orange County's homeless.



Scott Larson
Executive Director

HomeAid touched our heart and provides for those in need. Precious Life opened its doors in 1989 (the same year as OC HomeAid) with 10 transitional beds for homeless pregnant women, 18 and older, who had been abandoned by the father of her child. We quickly realized that women were living much longer than needed on the street with no place to stay. Precious Life approached HomeAid with a proposal to build a six-bed emergency shelter, with office, counseling room and living quarters for a house manager.

In 1997, Precious Life contacted HomeAid with a proposal for an entirely new idea, that we called our "Single Parent Efficiency Units." Built by Warmington Homes, this program allowed the mother and infant to stay until the child was 24 months old, providing she was a working mom.

Now, we once again have rekindled our HomeAid relationship as Phase Three of Precious Life Shelter is taking shape.

At Precious Life we believe relationships are built by working as a team, and we have been fortunate, indeed, in creating a strong partnership with HomeAid Orange County and their associates. We are indebted, grateful and strengthened as a result of working with all of the generous professionals who have come together on behalf of this worthy cause. From our hearts we thank HomeAid and all the builders, trade partners and volunteers who have given so generously to bring about change.



Theresa Murphy
Executive Director, Precious Life Shelters

Role model

Izzy Chooses Life

was nineteen years old, scared and angry. Not only was I five months pregnant, I was not married, deserted by the one who supposedly loved me. My parents thought it would be in my best interest to live elsewhere, on my own. This would be my chance to experience what the world has to offer a single mother. Not knowing where to turn to whom to turn, I found myself checking into Precious Life Shelter. Alone, by myself, I gathered my belongings bitterly and moved into my room along with two other girls in a similar situation. This was my home for the next 4 months.

The first thirty days that I stayed at Precious Life were horrible. I did not want to be there...I had no other choice. Family and friends opened their homes to me, but they had their own families to take care of. They didn't need me hanging around interfering in their private lives... PLS was there for me, willing to help me out. The support that I received was outstanding, all the women who worked or volunteered at PLS were amazing. They supported me in my decisions and were always there for me to talk to. Remaining at Precious Life Shelter was for my own good. I had no other choice but to get my act together....

Throughout the months I found out that it was important for me to remain a full time student. Staying in school allowed me to keep focused for my future's sake, keeping my mind occupied. I did everything that I could to stay in school. I spoke to my teachers to inform them when the baby was due and we thought of a plan for when I did go into labor... I let my teachers know how important it was for me to stay in school and they all agreed. They expressed to me how proud they were to see my perfect attendance all semester. The encouragement means a lot to me and kept me even more motivated. I was not going to give up that easily.

Throughout my pregnancy I was going through counseling. The counseling was for making one of the most difficult decisions I have ever had to make, adoption. Living out on my own, no father involved and learning the hard way made me realize what it would be like to raise a baby alone. This was an option that I had to make for the sake of my unborn child. I knew that this would be the best choice for her and I wanted her to have it all....I truly feel confident in my decision for my baby. I know that this is the best life for her and myself. I learned a lot while walking my path and my eyes now are wide open, forever. I love my baby with all my heart and she will always be my daughter. For her new parents, I love them dearly and I feel so proud to have given them the gift they have been waiting for, little baby Kaitlin.

Thank you Precious Life for all of your love and support and I thank God for leading me to your open door!

Love Always,
Elizabeth (Izzy)



HOMEAID UPDATE STAFF

HomeAid Update is published by
HOMEAID ORANGE COUNTY
9 Executive Circle, Suite 100
Irvine, CA 92614
Tel: (949) 553-9510
Fax: (949) 224-1855
E-mail address: homeaid@ni.net
Website: www.homeaidoc.org



President: Les Thomas

Executive Director: Scott Larson

Special Events Manager: Gina Economakos

Public Relations / Communications Manager: Delene Garbo

Administrative Manager: Julia Ung

Art Director: Dwayne Cogdill / Cognition Design

2000 PROJECT

Update

Creative Design Consultants Add Special Touches to Emmanuel House *HomeAid Orange County's First Shelter Project Dedicated to Persons Living With HIV/AIDS*



Sticks and stones may build a house, but it's the special touches that make a home. Thanks to national model home designer, Creative Design Consultants, Santa Ana's Emmanuel House, California's first new shelter for homeless persons living with HIV/AIDS, promises to be a show-stopper!

The difference is in the details, and CDC is sparing no effort in fine-tuning the particulars to create a stunning ambience for Emmanuel House's special residents. No more institution green with its accompanying cracked painted molding. No miss matched carpet swatches or stained linoleum floors. Only state-of-the design that is both functional and aesthetically pleasing for the occupants soon to be living in this special place.

According to CDC president, Dana Eggerts, Emmanuel House interiors promise to be anything but typical. "The clinical atmosphere generally found in similar environments will give way to an inviting ambience," said Eggerts. "Our staff pulled out all of the stops with their team-spirited approach to create a design that is a perfect fit for the need."

Creative Design Consultant's Emmanuel House project manager, Brooke Schneider, has been successful in acquiring more than 50% of the project's interior components. "Thanks to our generous vendors we have been successful in gathering the lion's share of furnishings needed to complete the interior design," said Schneider.

Contributors to Emmanuel House interiors include: Arcadian Gallery of Corona, who provided the upholstered items for the living room, entry and TV lounge; Medina Concepts, Riverside who is contributing the dining room tables; Marlin Furnishings of Tustin, who is supplying all of the dining room chairs and wooden tables; and Kojo Industries, who is supplying 21 bedspreads for the resident guestrooms.

Located in Santa Ana, California's historic French Park district, the 16,000 plus square-foot, two story Emmanuel House, designed by architect Phil Hove, and RNM Architects and Planners, and built by WL/John Laing Homes, will resemble a large, single-family, two-story home. The project is HomeAid's second for Mercy House Transitional Living Centers, which will manage the operations of the 21-bed shelter.



LAURA'S HOUSE *A Dream in Progress*

Cooperative efforts between Talega Associates, Bassenian/Lagoni, the City of San Clemente, HomeAid Orange County, and a variety of other organizations continue in an effort to bring about the dream of Laura's House Transitional Living Center.

Expected to be completed in 2002, the 16,000 square-foot Spanish Colonial building will have six apartment units, a counseling center, legal services and children's center. Talega Associates who is in the process of lining up consultants, subcontractors and suppliers, is serving as master builder captain. Architect, Bassenian/Lagoni is working in close contact with the City of San Clemente to complete the plan details of the project.

Laura's House serves abused women and children who need a temporary safe home and an opportunity to rebuild their lives.



TALEGA
OF SAN CLEMENTE

SHEA LUNCHEON

Shea Homes Southern California Division recently held a luncheon to honor those trade partners who gave of their time and talent to build Interval House, a safe house for victims of domestic violence. HomeAid Orange County joins Shea Homes in saying thank you to everyone who gave so generously.

SheaHomes
A Distinct Difference

Gold Nugget Awards



(From Left) Scott Larson, Ken Niemerski (Bassenian/Lagoni), and Les Thomas

For 37 years, the Gold Nugget Awards have honored an exceptional roster of winners. This year's honorees emerged from 594 entries submitted from the 14 Western United States and Countries from the Pacific Rim. The awards were presented at the Pacific Coast Builders Conference held in San Francisco on July 24-27.

HomeAid garnered four out of the six Gold Nugget Builder Industry Community Spirit Awards.

The winning projects from HomeAid Orange County were: Orangewood Children's Home serving severely abused children, builder; Fieldstone Communities, with William Hezmalhalch Architects; Habitat for Humanity Duplex for families without homes, builder; Lennar Homes, with BBG Architects; and Interval House serving battered women and their children, builder; Shea Homes, with architects, Eric Mossman, AIA and Bassenian/Lagoni Architects. HomeAid Sacramento won the award for The Acorn Residence, project builder is Beazer Homes, with architects, Bloodgood Sharp Buster.

Sponsored by First American Title Insurance, the Community Spirit Awards demonstrate the immense reservoir of caring and concern from within the building community.

All Systems Go to Start Village of Hope

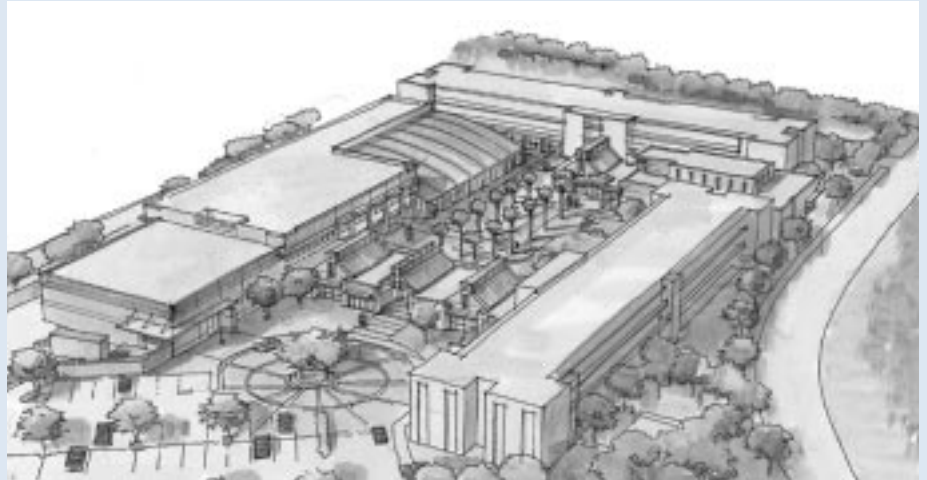

The Village of Hope project will be the first conveyance of the Marine Corp Air Station in Tustin. Once title transfer is completed, maybe as soon as this September, construction can begin. In the meantime Oltmans Construction is working on the budget and cost estimates for the project, while Gensler, and Access Architecture, the architects for Village of Hope, are working on changes to the plans for the new construction. Designer, Oma Tally, has completed the design of the on-site models, which may be toured at the site.

Scheduled to open in 2001, the barracks previously occupied by the military, will house families for up to 18 months. Working in partnership with HomeAid Orange County, the Orange County Rescue Mission, the care provider for Village of Hope, will focus on helping homeless men and women work toward self-sufficiency through education, vocational training, and job placement.



Oltmans
CONSTRUCTION CO.

HOMEAID DONORS

CORPORATE CONTRIBUTORS

President's Circle

Burrow Escrow

Founder

Builder & Developer Magazine

The Irvine Company

Los Angeles Times, Orange County

Benefactor

First American Title Insurance Company, Inc.

Patron

California Federal Bank

Downey Savings

Ernst & Young, LLP

William Lyon Homes

Foundation Supporters

The Fieldstone Foundation

Irvine Health Foundation

Pacific Life Foundation

Staples Center Foundation

MISSION STATEMENT

To build or renovate shelters for the temporarily homeless, with the goal of adding to the number of shelter beds available in Orange County.

VISION STATEMENT

Building hope and homes for Orange County's temporarily homeless

THE HOMEAID MISSION

HomeAid was founded in 1989 in Orange County, California, by the Building Industry Association of Orange County (an affiliate of the National Association of Home Builders) as a 501(c)3 charitable organization with the mission of building or renovating shelters for the temporarily homeless.

HomeAid serves individuals and families who find themselves without shelter due to factors such as domestic violence, job loss, catastrophic illness and crisis pregnancy. To date, HomeAid has raised over \$14 million in in-kind contributions resulting in the addition of over 500 additional shelter beds benefiting thousands of men, women and children in Southern California.

BURROW ESCROW PRESENTS...SURFIN' USA *6th Annual Gala Benefiting HomeAid Orange County*



(From L - R) Brenda Silvey, HomeAid Orange County board member, Donna Hahn, HomeAid Orange County board member and Gina Economakos, HomeAid Orange County events manager live it up at the recent Burrow Escrow Surfin' USA blast.

On Friday, July 21, 2000 the dedicated staff of Burrow Escrow, led by HomeAid Orange County board member, Cheryl Wyland successfully orchestrated another fundraiser benefiting the temporarily homeless. Surfin' USA, held at the Tustin Ranch Golf Course raised over \$25,000 for HomeAid's Shelter Development Program.

Thank you to the following sponsors for their support and generosity.

BIG KAHUNA

First American Title Insurance Company, Inc.
Fluor Corporation
P.D. Rabbit Messenger Service

COWABUNGA

Guardian Title Company
Imperial Bank
Orange County Escrow Association
Title Temps

HANG TEN

American Title Company
Benefit Land Title
Commonwealth Land Title Company
Orange Coast Title Company
National Messenger

LIL DEUCE COUPE

Bassenian/Lagoni Architects
Comerica Bank
Commonwealth Service Corporation
Creative Cuisine
Growth Funding Corporation
Michael Haas, CPA
Patrick McGinnis, CPA

Mid-Exchange, Inc.
North American Title Company

Schick Data Bank

DONORS

Marion Anderson
Kathryn Beilstein
Julia Boyton
Joseph Borlase Jr.
Mary Ann Chamberlin
Peggy Desantis
Sandy Fainburg
Pat Faris
Fidelity National Title
Elenor Gann
Helen Neiger Gilchrist
Ken Kelly
Bill MacDonald
Terry Manatos
Paul & Shirley McCracken
Donald Miller
Roger Neu, Esq.
Joyce Rasch
North Hills Realty
Carole Seulle
Harold and Pasty Thomas

SPECIAL THANKS

PPS Perking, Inc.
Regal Rents

BRITISH AMERICAN BUSINESS COUNCIL ORANGE COUNTY

*Founder's Reunite for the 10th Anniversary
Casino Night and Golf Tournament
Benefiting HomeAid Orange County*

Founding board of directors and members of the British American Business Council Orange County (BABC-OC) chapter will celebrate their 10th anniversary during a Casino Night on September 16 at Bauer Jaguar in Santa Ana, followed by the Founder's Golf Tournament on September 18 at the spectacular Marbella Country Club in San Juan Capistrano.

Don't miss the excitement at the Casino Night which features a \$10,000 putting contest, drawing for round trip tickets to London on Virgin Atlantic, a fabulous live and silent auction and a Chinese auction for all those lucky gamblers. If putting isn't your forte' try the Million Dollar shoot-out at the golf tournament sponsored by Chelsea Mortgage. Reserve your spot today by calling the BABC at (714) 545-2222 or view the BABC-OC web site at www.baboc.org.

P.A.S.S. BEACH PARTY

*"A Tribute to Purchasing Agents,
Subcontractors and Suppliers"*

HomeAid partnered with the Building Industry Association Orange County Chapter at their annual P.A.S.S. Beach Bash held on Wednesday, August 23, 2000 at the Newport Dunes. Over 300 guests enjoyed a late afternoon of relaxation where they could network and develop profitable business relationships.

HomeAid Orange County hosted nearly 100 of their trade partners as a thank you for their generosity and dedication of building hope and homes for the temporarily homeless in our community.



Timi Flowers, director of purchasing for Centex Homes, and Jim Gates of Gateway Drywall Company, a participant in nine HomeAid Orange County shelter projects, join purchasing agents, subcontractors and suppliers at the recent P.A.S.S. Beach Bash.

RAINBOW OF HOPE BALL

Recognizes Honorees in Six Categories



(From Left) **Kathy Killins**, Sub-Contractor of the Year – Paragon Insulation; **Dave Merchant**, Corporate Partner, Los Angeles Times, Orange County

homeless population residing in Orange County.

The Rainbow of Hope Awards presentation ceremony was the highlight of the evening's festivities. Awards were presented to: H. Lawrence Webb, president of WL/Laing Homes, Builder of the Year; Don Jacobs, JBZ Architects + Planning garnered outstanding Volunteer; and Lawrence Haynes, Mercy House Transitional Living Centers was presented with the Care Provider of the Year Award. The *Los Angeles Times*, Orange County garnered the Rainbow of Hope Corporate Partner

Award; General Electric was honored with the Supplier of the Year Award; and the Rainbow of Hope Sub-contractor Award went to both Paragon Insulation and Peterson Brothers Construction, who were tied for this honor.



(From Left) **Eldon and Kerry Peterson**, Sub Contractor of the Year, Peterson Brothers Construction; **Don Jacobs**, Outstanding Volunteer – JBZ Architects + Planning and wife, **Julie Brinkerhoff**

Housing Partners; JBZ Architecture + Planning; The Irvine Company; Oltmans Construction Company; Sanwa Bank; William Lyon Homes; and WL Homes.

Without the countless hours, cash, and in-kind contributions donated by the building industry, their associates, and corporate partners, many homeless men, women and children would still be living on the streets. Our heartfelt thank you to all who made the Rainbow of Hope such an outstanding event!

Emotionally charged glamour and glitz permeated the packed house at the Four Season's Hotel, where HomeAid Orange County recently hosted the building industry and their associates at the second annual Rainbow of Hope Ball.

The \$165,000 plus revenues generated from corporate sponsor donations and a silent auction will benefit HomeAid Orange County's shelter development program for the temporarily



(From Left) **H. Lawrence Webb**, Builder of the Year – President of WL/John Laing Homes; **Lawrence Haynes**, Care Provider of the Year – Mercy House Transitional Living Centers

development program for the temporarily

A significant portion of the revenues generated were the result of corporate sponsor donations. Participating corporate sponsors contributing \$5,000 or more to the Rainbow of Hope Ball are: Capital Pacific Holdings, Inc.; E&Y Kenneth Leventhal; First American Title Insurance Company; Infiniti West Regions; Institutional



(From Left) **Carl Neuss**, chairman of Rainbow of Hope Ball 2000; **Bud Hurst**, Supplier of the Year, General Electric

HOMEAID ORANGE COUNTY BOARD OF DIRECTORS

Les Thomas, President
Shea Homes

Jay Blakslee, Treasurer
J. Danner Corporation

Val Celestin, Secretary
Interiors by Valerie

Brenda Silvey
V.P. Fundraising

Larry Buster
First American Title Insurance Company

Greg Currens
AMH Golf Corporation

Steve Esser
Pro Heating & Air

Mike Grubbs
William Lyon Homes

Donna Hahn
Hahn Communications

Bart Hansen
Nieupointe Enterprises

Stephen E. Hester
Trimark Pacific Homes

Sonia Lister
Morrison & Foerster, LLP

Carl Neuss
Institutional Housing Partners

Tim Paone
Paone, Callahan, McHolm and Winton

Lee Rogaliner
Bassenian/Lagoni Architects

Ron Saienni
Biltmore Communities, Inc.

Michael Schlesinger
Taylor Woodrow Homes

Nick Slevin
Builder and Developer Magazine

Chuck Trevisan
Irvine Community Development Company

Cheryl Wyland
Burrow Escrow

To become involved in HomeAid's Shelter Development Program contact HomeAid in the following ways:

Telephone: 949-553-9510

Fax: 949-224-1855

E-mail: Homeaid@ni.net

Website: www.homeaidoc.org

Project Playhouse

FOR MORE INFORMATION CALL HOME AID (949) 553-9510

PLAY FOR KEEPS

*HomeAid's 9th Annual
Project Playhouse*



Opportunity playhouse display begins September 1, 2000 – tickets are available at the Fashion Island concierge or by calling HomeAid.

Project Playhouse Premier Party

Don't miss your only chance to see the inside of the playhouses on Saturday, September 23, 2000 from 2:00PM – 6:00PM. \$15 General Donation

Project Playhouse Village Tours

Begins Sunday, September 24, 2000 through Saturday, October 21, 2000
Weekends Only from 11:00AM – 5:00PM \$5 General Donation

Project Playhouse Auction Party

Saturday, October 21, 2000 at 5:00PM
At Fashion Island, Newport Beach
Pre-Paid Tickets are \$25 - \$35 at the door
\$15 Children (12 to 4 years old – 3 and under are free)

Major Sponsors

BCI Framing & Drywall
Bragg Crane Service
Builder & Developer Magazine
Burrow Escrow
City National Bank
Countrywide Home Loans
Eldorado Bank
Envision Productions, Inc.
Ernst & Young, LLP
Fashion Island
First American Title Insurance
Harris Fence Company
Key Bank
L.A. Parent
Los Angeles Times, Orange County
Miller Brothers Investment, LLC
OC Metro/OC Family
Orange Coast Magazine
Pennysaver
PMI Mortgage Company, Inc.
ProHome
Regal Rents
Shea Homes/Shea Properties
Standard Pacific of Ventura
Stauffer's Landscape
The Gas Company
The Irvine Company
William Lyon Homes

Builders

CWI Development
New Urban West, Inc., for Cox, Castle & Nicholson, LLP
Cannon Constructors, Inc./David Rolfe ASLA
ETCO Development
The LeBon Family with Dave Mulvaney
Newport Beach Fire Fighters
Osborne Development
Pacific Design Estates
Pardee Homes
Rancho Mission Viejo with Warmington Homes
Shea Homes – Los Angeles Division
Standard Pacific Homes
Taylor Woodrow Homes
William Lyon Homes

Project Playhouse



HOME AID ORANGE COUNTY

9 Executive Circle, Suite 100

Irvine, California 92614

Non-Profit
Bulk Rate
U.S. Postage
PAID
Irvine, CA
Permit No. 339